

Stainless steel fluorine lined basket strainer (SBLFEP/PFA)

**Main parts and materials**

Name/Material	WCB	CF8	CF3	CF8M	CF3M
Body	WCB	CF8	CF3	CF8M	CF3M
Screen	FEP / PFA / PO / PTFE				
Lined	FEP / PFA / PO / PTFE				
Bolt/Nut	B7/2H	B8/8	B8/8	B8M/8M	B8M/8M
Fineness : 10Mesh ~ 100Mesh					

Technical Specification

Design&Manufacture Standard	GB/T12234		API 6D
FTF Dimension Standard	HG/T3704, GB/T12221		ASME B16.10
Flange standard	HG/T20592, GB/T9119		ASME B16.5, JIS B2220
Inspection & Test Standard	HG/T13927, JB/T9092		API 598
Normal Diameter	DN25~DN300		1"~12"
Normal Pressure	1.0MPa	1.6MPa	150LB
Test pressure	Shell Test	1.5MPa	1.5MPa
	High Pressure Test	1.1MPa	1.1MPa
	Low Pressure Test	0.6MPa	0.6MPa
Temperature Range	FEP:-29℃~120℃, PFA:-29℃~180℃, PTFE:-29℃~150℃		
Applicable Medium	Strong corrosion medium: Hydrochloric acid, Nitric acid, Hydrofluoric acid, Liquid chlorine, Sulfuric acid and Aqua regia etc.		

氟材料压力温度曲线  
Pressure-Temperature Curve

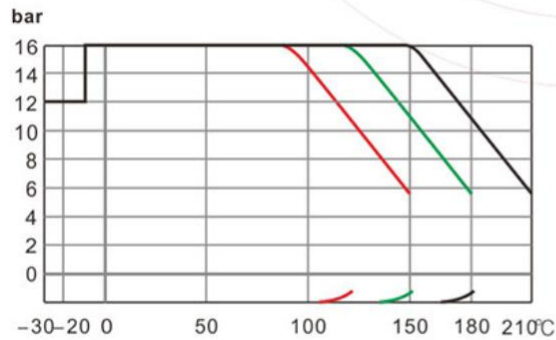

真空 Vacuum: 0.1mbar  
备注 Note: — PFA — PTFE — FEP

流量特性图  
Flow Characteristic

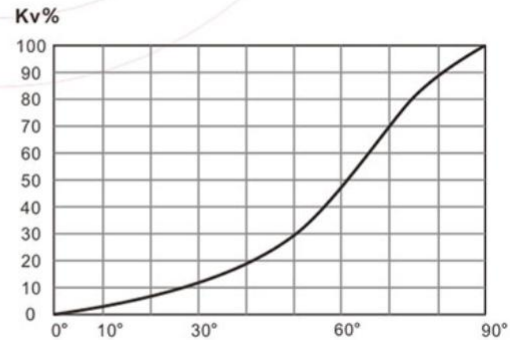

阀位角度 Valve Position Angle  
1Cv=1.167Kv

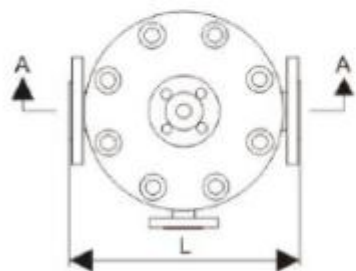
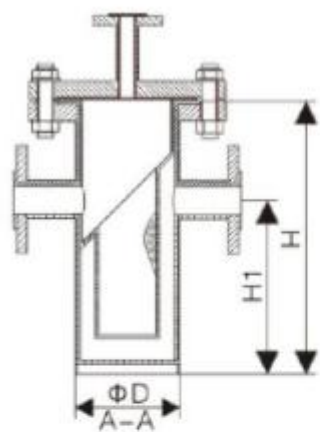

DN25-DN100

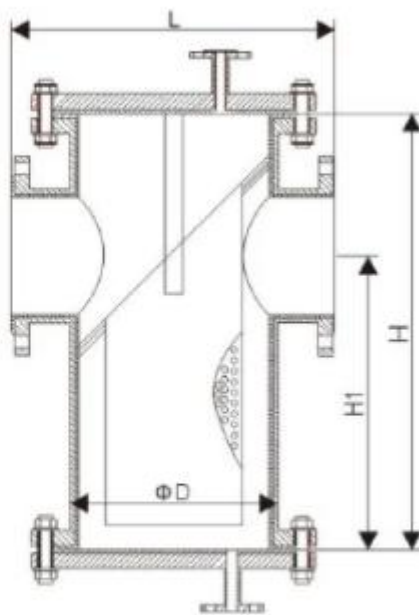

DN125-DN250

**The main connection size**

DN (MM)	INCH	L	ØD	H	H1
25	1	260	108	330	200
32	1-1/4	260	108	330	200
40	1-1/2	260	108	330	200
50	2	260	108	330	200
65	2-1/2	340	159	430	285
80	3	340	159	430	285
100	4	400	219	490	305
125	5	500	273	635	420
150	6	500	273	635	420
200	8	560	325	785	525
250	10	660	426	895	640
300	12	720	426	650	350
350	14	960	630	650	350
400	16	960	630	650	350